

DOOR LOCKING GEAR

Door locking external and recessed cam lock kits for rear and side locking doors.

286 DOOR LOCKING GEAR

290 DOOR LOCKING GEAR - CAM LOCK

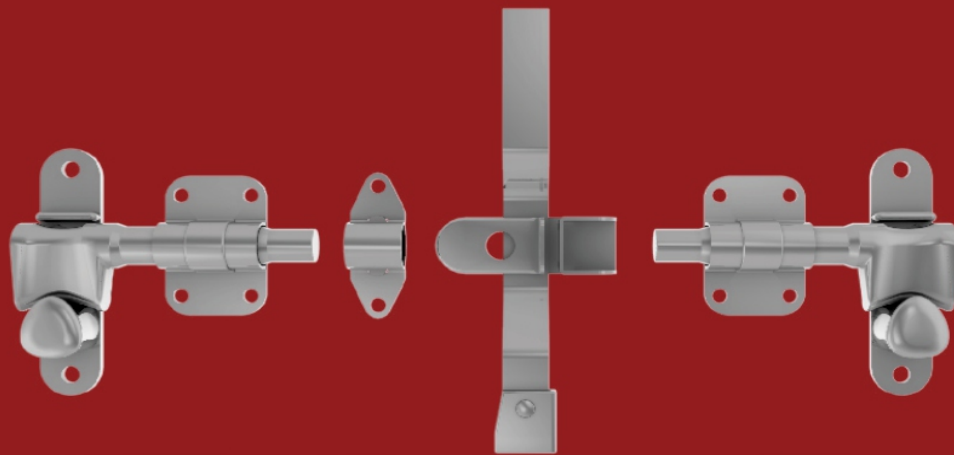

DOOR LOCKING CAM KIT
60000S



BE1000
DOOR LOCKING GEAR

DESCRIPTION

Light duty cam lock. Material: forged steel;
Bearing brackets: mild steel zp; Finish: ZP;
Suits Pipe 22mmOD; Pipe not supplied.

SPECIFICATIONS

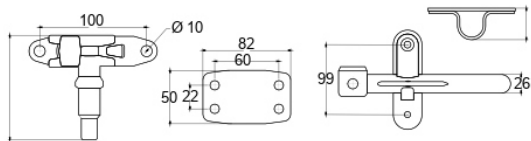

BE1000



Item No.	Description	QTY
1	CAM	2
2	KEEPER	2
3	F- HANDLE	1
4	BEARING BRACKET OUTER LARGE	2
5	BEARING BRACKET INNER LARGE	2
6	BEARING BRACKET OUTER SMALL	1
7	BEARING BRACKET INNER SMALL	1
8	RETAINER CATCH WITH SECURITY HOLE	1
9	F-RETAINER PLATE	1
10	BUSH	1
11	HANDLE HUB	1
12	RIVET	1
13	TUBE Ø 27x3000mm (optional)	1

BE2000
DOOR LOCKING GEAR

DESCRIPTION

Zinc Plated
4.805kg
Medium Duty Cam Lock
Suits 27mm OD Pipe
Pipe not supplied

SPECIFICATIONS

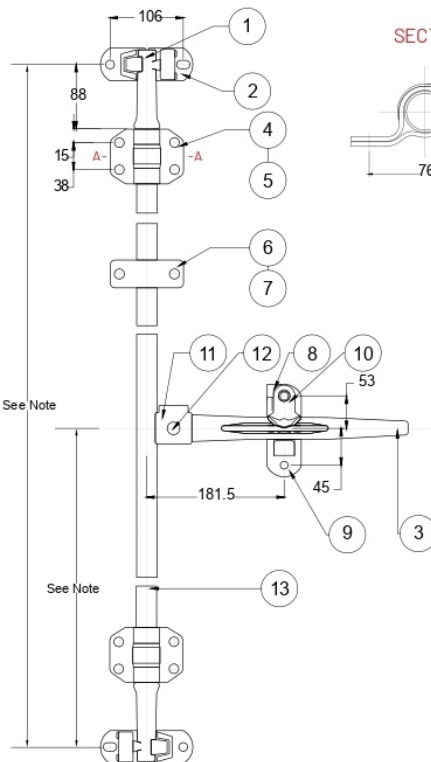

SECTION A-A

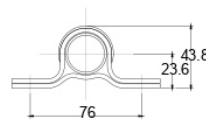

BE2000

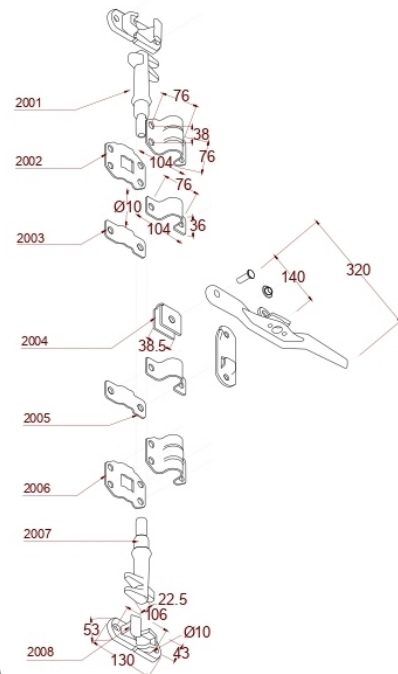
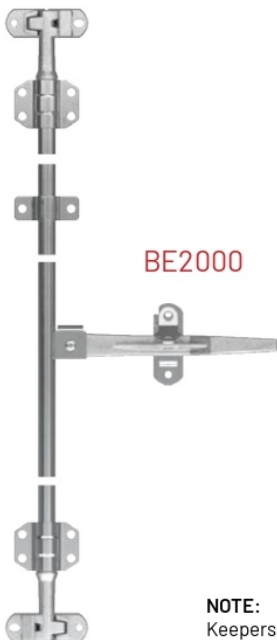

NOTE:
Keepers with elongated hole (10mmx15mm) and round hole (10.2mm)

TI-3WO
DOOR LOCKING GEAR

MATERIAL
Forged Steel

FINISH
Zinc Plated

DESCRIPTION

Cam lock H/duty.
Weld on.
Suits 34mm OD Pipe.
Pipe not supplied.
(Bolt on keepers available on request)

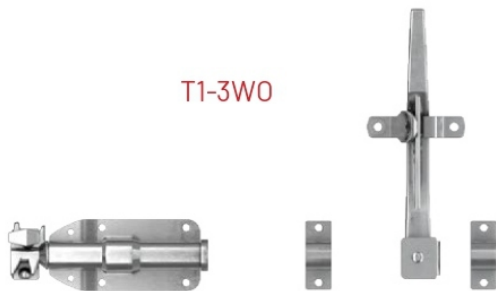

TI-3WO

Item No.	Description	QTY	Item No.	Description	QTY
1	RIVET	1	8	CAM LH	1
2	BUSH	1	8	CAM RH	1
3	HANDLE HUB	1	9	BEARING BRACKET INNER SMALL	2
4	F-RETAINER PLATE	1	10	BEARING BRACKET OUTER SMALL	2
5	RETAINER CATCH WITHOUT SECURITY HOLE	1	11	BEARING BRACKET OUTER LARGE	2
6	F-HANDLE	1	12	BEARING BRACKET INNER LARGE	2
7	KEEPER L.H	1	13	ANTI RACK RING	4
7	KEEPER R.H	1	14	TUBE Ø34x320mm (optional)	1

SPECIFICATIONS

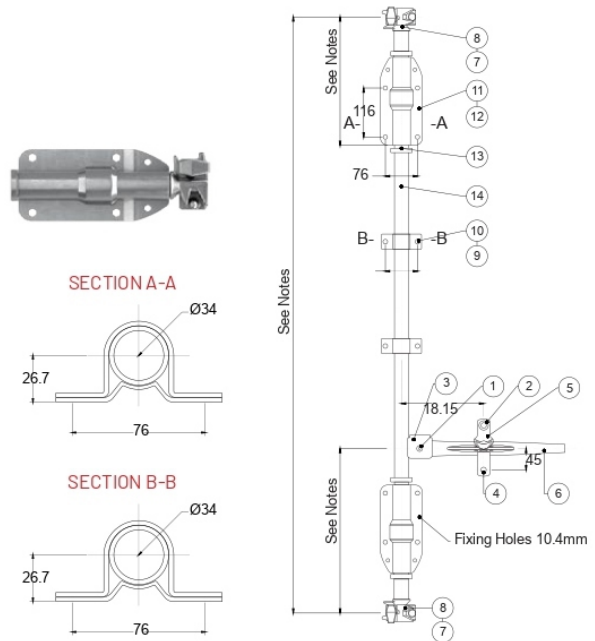

TI-3BOKEEPER
DOOR LOCKING GEAR

DESCRIPTION

Heavy Duty Keeper Bolt On
Handed Options - Left or Right

SPECIFICATIONS

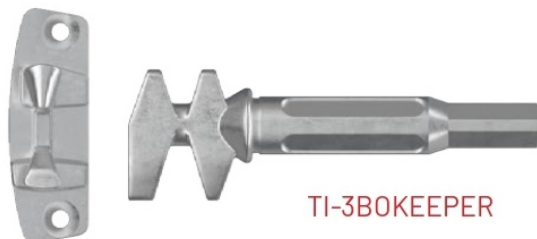

TI-3BOKEEPER

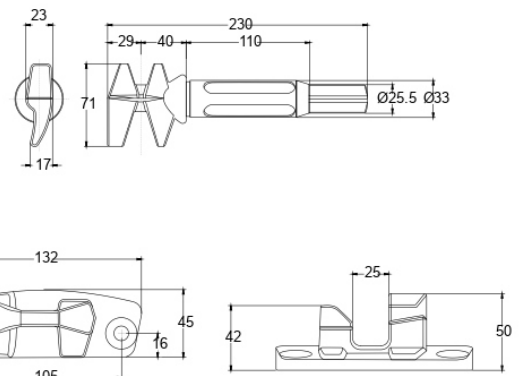

60000 / 60000S
DOOR LOCKING GEAR

MATERIAL
Forged Steel / Stainless Steel

BRACKETS
Mild Steel / S/Steel

FINISH
Zinc Plated / Polished S/Steel



DESCRIPTION

- Suit Pipe 27mmOD
- Door locking system
- Suits truck rear doors;
- 60000: Bearing brackets pressed m/s
- 60000S: Bearing brackets pressed s/s
- Pipe not supplied

SPECIFICATIONS

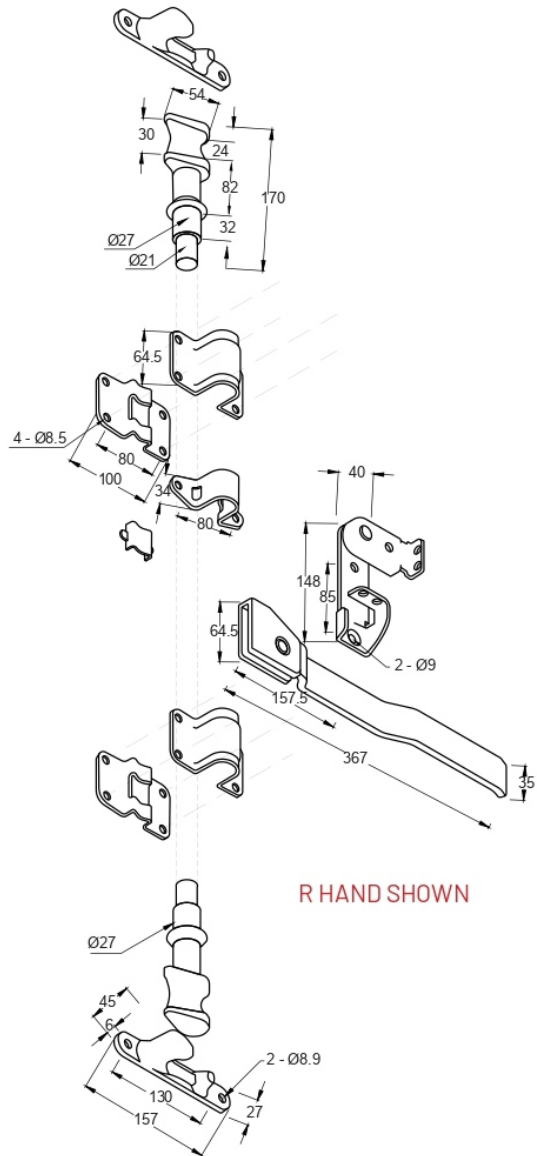

60000-34 / 60000S-34

DOOR LOCKING GEAR

MATERIAL

Forged Steel / Stainless Steel

FINISH

Zinc Plated / Polished Stainless Steel

DESCRIPTION

Heavy duty cam lock.

Suit Pipe 34mmOD

Door locking system

Handed - left or right.

60000-34 : Bearing brackets pressed m/s

60000S-34: Bearing brackets pressed s/s

Pipe not supplied

Option: Zinc Plate or Stainless Steel



60000-34



60000S-34

SPECIFICATIONS

60000S-34

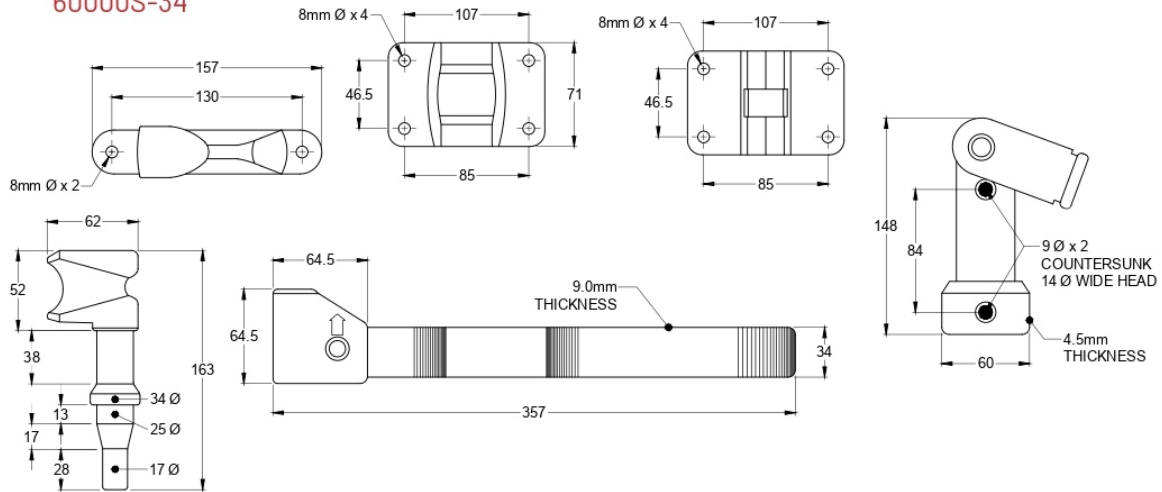

Right Hand Shown - Drawing

****More cam lock variations available on request ****